

PROJECT NAME and ADDRESS

THIS SPACE RESERVED FOR THE CITY

Builder Logo (if applicable)

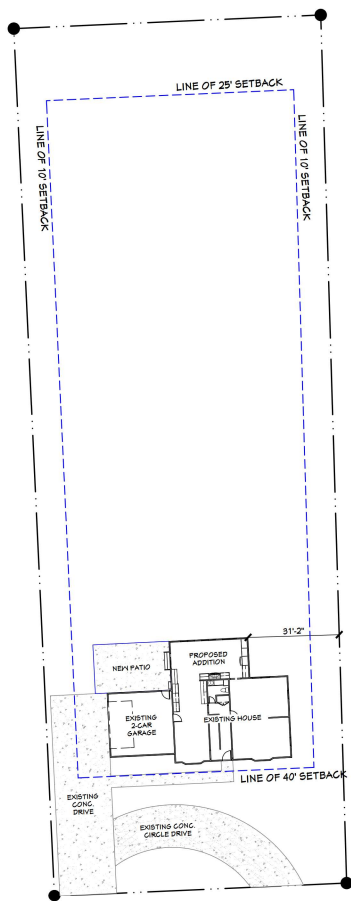

ADDRESS

SUBDIVISION



Project Details

TABLE OF CONTENTS	
SHEET	TITLE
1	COVER PAGE & SITE PLAN
2	EXISTING ELEVATIONS
3	NEW ELEVATIONS
4	NEW 3D PERSPECTIVE VIEWS
5	EXISTING/DEMO FLOOR PLANS
6	NEW FOUNDATION FLOOR PLAN & WALL SECTION
7	NEW MAIN FLOOR PLAN
8	EXISTING/DEMO ROOF PLAN, NEW ROOF PLAN & DETAILS

	EXISTING SQ. FT.	ADDITION SQ. FT.
MAIN FLOOR	1,128	1,578
TOTAL	1,128	1,578

SITE PLAN
SCALE: 1" = 20'-0"

GENERAL PLAN NOTES

These working drawings have been prepared by VirtuActive, LLC to meet average building conditions and were designed under standard interpretation of the 2012 International Residential Code (IRC 2012) and the amendments adopted by the local jurisdictions. Because codes and requirements can change and may vary from jurisdiction to jurisdiction, VirtuActive, LLC cannot warrant compliance with any specific codes or regulations. Therefore, each individual contractor, sub-contractor, and supplier on the jobsite should consult their local building official to determine the appropriateness between the plan and actual jobsite conditions and applications.

CONCRETE and FOUNDATIONS:

Footing design assumes 1500 PSF allowable bearing pressure. Foundation wall designs assume 30 PSF equivalent hydrostatic pressure. Concrete contractor to verify soil conditions prior to concrete placement.

Re-erforcing footing as follows:

- Spread footings - as noted on plan
- 20"x10" continuous footing (3) #4's cont..
- 16"x8" continuous footing (2) #4's cont..
- Deck piers - 18"x42" deep - below grade (no rebar required)

Provide footing dowels to match vertical wall reinforcing.
Reinforcing bars shall be Grade 60 or better.
Concrete contractor to provide ground rebar in footing for electrical contractor.
All concrete shall be min 3000 PSI (28 day comp strength).
All footings shall be a min of 42" below finished grade or deeper.
Anchor bolts must be at least 5/8" in diameter and must extend at least 7" into concrete. There must be at least 2 anchor bolts per plate section on walls longer than 24".
Anchor bolts must be spaced no more than 6" on center.
One anchor bolt must be located not more than 12" from each end of the plate section

Contractors, sub-contractors, and suppliers shall be aware of and responsible for, but not limited to, the following:

1. Contractors, sub-contractors, and suppliers shall verify all conditions and dimensions prior to construction and be solely responsible for any changes necessary as a result of conditional or dimensional differences.
2. Contractors, sub-contractors, and suppliers shall verify all dimensions and elevations against the plan and actual site conditions.
3. Calculated dimensions take precedence over scaled dimensions.
4. All dimensions are from framing edge, unless otherwise noted.

STRUCTURAL and FRAMING:

All structural members are for bidding purposes only. All structural member sizes shall be verified by the contractor, sub-contractor, and/or supplier.
All additional structural members required for specific framing techniques shall be sized by the contractor, sub-contractor, and/or supplier.
All steel pipe columns shall be 3.5", unless otherwise noted.
Ceiling joists and roof rafters to be roof truss construction. Sizing, spans, reinforcement locations, and depth to be provided by truss manufacturer.
Provide bridging as required by code.
All perimeter headers over openings to be (2) 2x12, unless otherwise noted.
Double floor joists under all parallel non-load bearing walls.
Provide double cripple studs under all LVL headers.
Provide let-in wind bracing as required.
No penetrations through any structural member (such as pipes, conduits, ductwork, etc.) shall be made.

REVISION TABLE	DESCRIPTION		
NUMBER	DATE	REVISOR	BY

These drawings were prepared by VirtuActive, LLC. VirtuActive, LLC and its employees and contractors shall not be held liable for any errors or omissions in these drawings. The user of these drawings shall be responsible for obtaining all necessary permits and approvals from the appropriate authorities. The user of these drawings shall be responsible for obtaining all necessary permits and approvals from the appropriate authorities. The user of these drawings shall be responsible for obtaining all necessary permits and approvals from the appropriate authorities.

PROJECT LOCATION:

PREPARED FOR:



DATE:

3/14/2019

SHEET:

1 OF 8